

## SPECS



### MAX /

C0416008 / STRUCTURE: Oak veneered MDF & Particle Board substrate. DOORS: Four hinged doors w/soft close mechanism. One interior fixed shelf per door. BASE: Black powder coated steel base w/plastic glides. FINISHES: Grey Oak.

C0416009 / STRUCTURE: Oak veneered MDF & Particle Board substrate. DOORS: Two hinged doors w/soft close mechanism. Three interior fixed shelves. DRAWERS: Two full extension central drawers. BASE: Black powder coated steel base w/plastic glides. FINISHES: Grey Oak.

C0416008

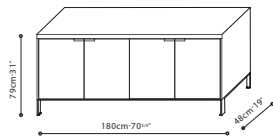

C0416009

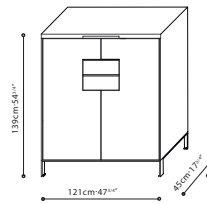

### Image of Cabinet's Interior

C0416008

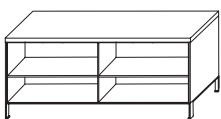

C0416009

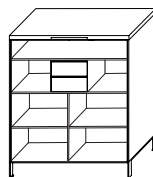

Grey Oak

\*Items mark in red are being phased out, check for availability before ordering.